

X-Station 2

Versatile Intelligent Terminal



X-Station 2 is a versatile multi-technology terminal for access control and workforce management, built around broad RFID card compatibility and fast, accurate fingerprint authentication. For compatibility, it also reads QR codes and barcodes via the built-in camera and supports Mobile Access when needed. Security and operations are reinforced by secure boot, Open Supervised Device Protocol (OSDP) over RS-485, and image logs, while Power over Ethernet (PoE), a 4-inch capacitive touchscreen, and an IP65-rated design simplify installation.

Suprema
SECURITY & BIOMETRICS

Key Features



Flexible Multi-Credential identification

X-Station 2 delivers multi-credential identification anchored in broad RFID support and fast fingerprint authentication. It also supports software-based QR/barcodes via the built-in camera and Mobile Access when required, enabling mixed-credential policies.



Comprehensive RFID Card Compatibility

X-Station 2 is compatible with most existing RFID card technology. It supports both LF (125kHz) and HF (13.56MHz) RFID as well as various card types including EM, MIFARE, MIFARE Plus, iCLASS, DESFire and Felica.



Enhanced Security and Data Protection

X-Station 2 guards against malware attacks and data breaches with secure boot process. By supporting OSDP (Open Supervised Device Protocol), the terminal encrypts bi-directional RS-485 communication. Using the built-in camera, X-Station 2 can also capture image logs for added security.



Designed for easy deployment and management

X-Station 2 enables convenient installation with less wiring by supporting Power over Ethernet (PoE) as well as various interfaces like Wiegand, RS-485, TTL input and Relay. IP65 rated, X-Station 2 is dust-tight, water resistant and easy to maintain.



World-renowned Fingerprint Recognition

X-Station 2 boasts the "Best-in-class" performance (5,000 template match/ sec) and the highest level of security in terms of Powerful CPU, MINEX-Certified Algorithm, Fake/Live Finger Detection, Fingerprint Template and Packet Data Encryption.

* The fingerprint module is only available in models of XS2-ODPB and XS2-OAPB.



Improved Usability of Intuitive UI on Touchscreen

X-Station 2 allows quick and easy access to features on its 4" wide capacitive touchscreen. You can also customize the display for branding purposes.



Expanded Capacity for More Users and Security Logs

X-Station 2's large memory can sufficiently meet enterprise needs. Its 16 GB Flash and 1 GB RAM can handle up to 500,000 users, 5 million text logs and 50,000 image logs.

Specifications

Model Name	XS2-ODPB	XS2-DPB	XS2-OAPB	XS2-APB
RF Option	125 kHz EM & 13.56 MHz MIFARE, MIFARE Plus, DESFire, DESFire EV1/EV2/EV3, Felica		125 kHz EM, HID Prox & 13.56 MHz MIFARE, MIFARE Plus, DESFire, DESFire EV1/EV2/EV3, Felica, iCLASS SE/SR/Seos	
RF read range ¹⁾	MIFARE, DESFire, iCLASS, HID Prox, EM: 50 mm / Felica: 30 mm			
Mobile Card	NFC, BLE			
QR/Barcode ²⁾	Supported ³⁾	Supported ³⁾	Supported ³⁾	Supported ³⁾
Biometrics	Fingerprint	N/A	Fingerprint	N/A
Scrambled Keypad (PIN)	Supported			
CPU	1.5 GHz Quad Core			
Memory	16 GB Flash + 1 GB RAM			
Crypto Chip	Supported			
Max. User	500,000 ⁴⁾			
Max. Credential (1:N)	100,000	N/A	100,000	N/A
Max. Credential (1:1)	Fingerprint: 500,000 Card: 500,000 PIN: 500,000	Card: 500,000 PIN: 500,000	Fingerprint: 500,000 Card: 500,000 PIN: 500,000	Card: 500,000 PIN: 500,000
Max. Logs	Text 5,000,000 / Image 50,000			
LCD	4" IPS color LCD / 480 x 800 pixels			
Camera	CMOS 2M pixels / 1600 x 1200			
Ethernet	10/100 Mbps, auto MDI/MDI-X			
RS-485	1 ch Host or Slave (Selectable)			
Wiegand	1 ch Input or Output (Selectable)			
TTL Input	2 ch Inputs			
Relay	1 Relay			
USB	USB 2.0 (Host)			
PoE	IEEE 802.3af compliant			
IP Rating	IP65			
Tamper	Supported			
Power	Voltage: 12 Vdc, Current: Max. 0.8 / Voltage: 24 Vdc, Current: Max. 0.5 A			
Dimensions (W x H x D, mm)	82 x 208.5 x 53 (Bottom) / 25.9 (Top)	82 x 159 x 25.9	82 x 208.5 x 53 (Bottom) / 25.9 (Top)	82 x 159 x 25.9
Operating Temperature	-20°C ~ 50°C (-4°F ~ 122°F)			
Certificates	CE, UKCA, KC, FCC, IC, RCM, BIS, ANATEL, SIG, TELEC, RoHS, REACH, WEEE (XS2-DPB, APB) CE, UKCA, KC, FCC, IC, RCM, BIS, ANATEL, SIG, RoHS, REACH, WEEE (XS2-ODPB, OAPB)			

1) RF read range will vary depending on installation environment. 2) Supports QR/Barcodes composed of up to 32 ASCII code strings.
3) Setting the QR/Barcode authentication method to Camera Frequency requires a separate device license. 4) The number of users registered without any credential data.

System Configurations

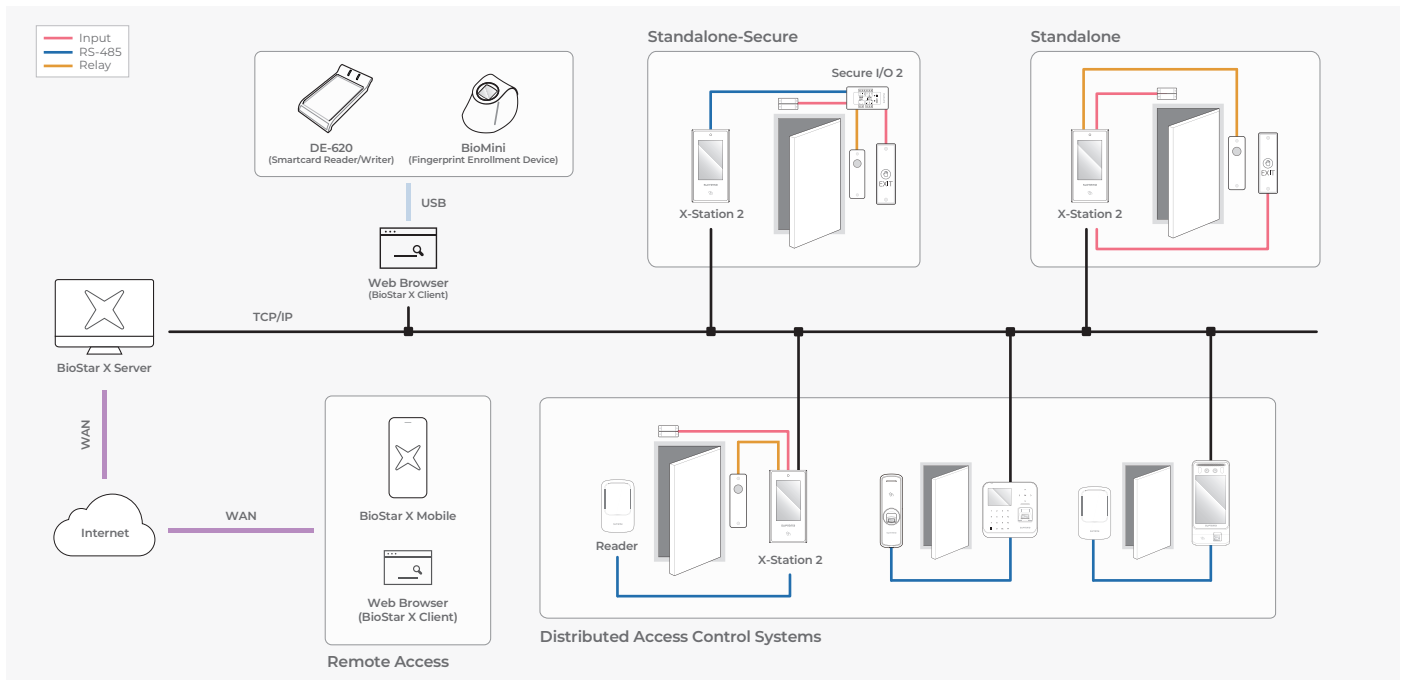

Suprema Inc.

17F Parkview Tower, 248, Jeongjail-ro, Bundang-gu, Seongnam-si, Gyeonggi-do, 13554, Republic of Korea
T +82 31 783 4502 **W** www.supremainc.com



For more information visit our website below by scanning the QR code.
<https://www.supremainc.com/en/about/contact-us.asp>